

# **ARB** **TOURING**



## **Awning 2500 Owners Manual**

**Congratulations on purchasing your  
ARB AWNING 2500 - the quick and easy way to enjoy camping.**

Included in this leaflet is all the information that you require to obtain the maximum enjoyment and benefit from your awning. Given proper care your awning will give you many years of trouble free camping.

## 1. Introduction

The ARB Awning 2500 has been designed to fit most roof rack and roof bar systems, horse floats, camper trailers and many other applications. This versatile product will give you many years of trouble free service providing you follow these simple mounting, operating and care instructions.

Before mounting the ARB Awning 2500 to your vehicle a few items need to be considered.

1. The ARB Awning 2500 is supplied with 6 - 6x20mm bolts and nylock nuts. Where the mounting is directly to the side of a roof rack, these bolts are usually all that is required.

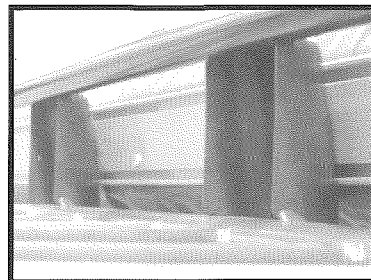

However, if you are mounting the ARB Awning 2500 to a set of roof bars or in conjunction with an ARB Touring Rooftop tent you will need an optional set of steel awning mounting brackets.

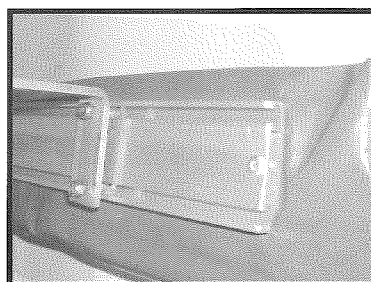

2. The ARB Awning 2500 needs to be mounted at a suitable height so that the doors of the vehicle can be opened without snagging the bottom of the awning.



3. The ARB Awning 2500 should be attached along its length at two points but preferably three points. Ensure that the unsecured length at each end of the awning does not exceed 700mm.

4. The ARB Awning 2500 should be attached using no less than 4 (6x20mm) nuts and bolts. Note: 6 nuts and bolts supplied, using 6 is preferable.

5. The mounting extrusion at the back of the ARB Awning 2500 will hold the head of the 6x20mm bolts captive. The bolts can be positioned anywhere along the length of the awning to correspond to the most appropriate mounting points.

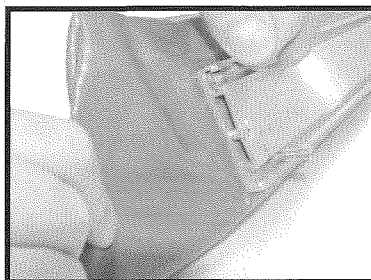

## 2. Fitting the ARB Awning 2500

### 2.1. Mounting to roof bars:

1. Fit your mounting brackets to the roof bars.
2. Position the awning on the roof bar brackets to determine the desired mounting position. Remember to consider opening of doors on the vehicle etc.
3. Insert the provided 6mm bolts into the mounting extrusion on the rear of the awning, and fit to the roof bar brackets, using the 6mm nylock nuts provided.

### 2.2. Mounting to roof racks:

1. Position the awning on the roof rack to determine the desired mounting position. Remember to consider opening of doors on the vehicle etc.
2. Mark and drill the roof rack (usually on the rise between the top rail of the roof rack and the base of the roof rack) to accept the bolts that will be fitted into the mounting extrusion.
3. Insert the provided 6mm bolts into the mounting extrusion on the rear of the awning, and fit to the roof rack, using the 6mm nylock nuts provided.

## 3. Storage and Care Guidelines

### 3.1. Cautions

- **Always secure the awning with pegs and guy ropes** . This will prevent the wind from lifting the awning and causing damage to your awning and/or your vehicle.
- **Do not store the awning wet.** The awning is made from 300gsm poly/cotton canvas and is fully waterproof. Whilst this material is resistant to fungal attack, mildew will form if the awning is stored wet for extended periods. The awning can be stored away wet for limited periods, but should be opened and allowed to dry as soon as possible.
- **In trip inspections.** Regularly check that all nuts and bolts attaching your awning to your vehicle are tight and in good repair.

### 3.2 Care for your awning

1. Use a soft brush to remove leaf litter etc. to prevent staining.
2. Where necessary you may use a sponge and mild soapy water to wash the awning material. After washing, rinse thoroughly with clean water and allow to dry before extended storage.

## 4. Set up Instructions:

1. Undo the zip on the PVC bag, and release the buckles holding the awning in place.

2. Release the awning rafter arms from the main aluminium extrusion. Swing both rafter arms slightly more than 90° away from the vehicle. See ①

3. Allow the awning to unroll in your hands to its full length. See ②

4. Release the legs of the awning from inside the front beam. Slide the inner leg tube to the desired height and engage the twist lock of the leg by turning the bottom half of the leg to lock the leg in place. See ③

5. With one hand holding the front beam, extend the rafter arm, and place the arm pin into the corresponding hole in the front beam. Twist the arm to engage the twist lock. See ④ and ⑤

6. Secure the fabric to the rafter arms using the velcro tabs.

7. Peg the legs to the ground using the rope loops in the feet, use guy ropes to secure in case of winds. See ⑥

8. Pack up is simply the reverse of the above procedure.

### 9. Note

- In the event of rain ensure that the awning is set to an appropriate angle to allow rain water to run off and not accumulate on top of the awning.

- In windy conditions it is essential that the awning be secured to the ground to prevent damage to the awning and to the vehicle.

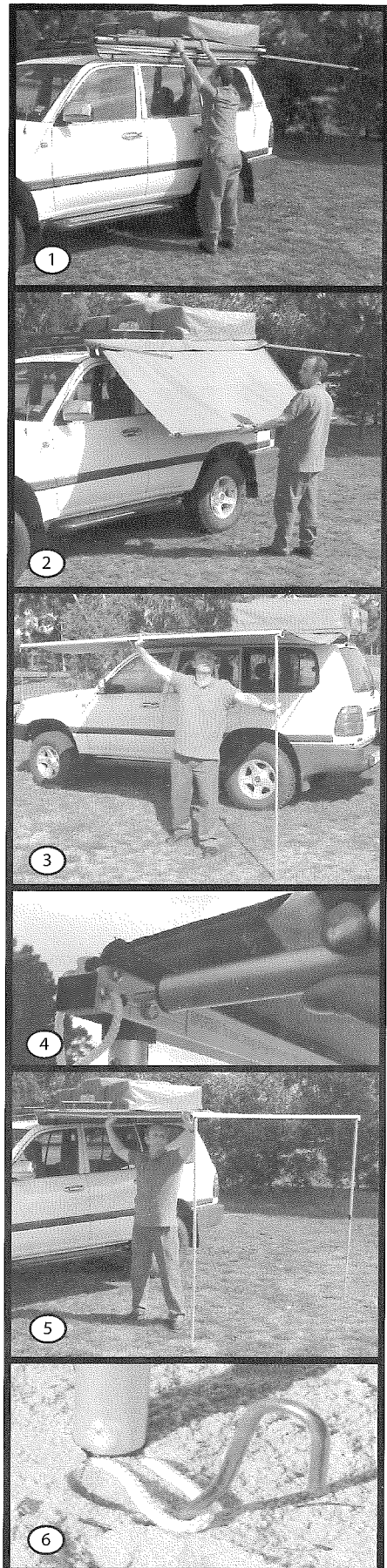

## 5. ARB Mosquito Net 2500



1. The ARB Mosquito Net 2500 can be quickly and easily attached to the erected awning.
2. Slide the rope cord with zip attachment into the front awning beam rope track.
3. Slide main body of the ARB Mosquito Net 2500 into the lower rope track on the main awning extrusion .
4. Zip the two sections together. It may be necessary to release the tension on the rafter arms to get the zip started. Once the ARB Mosquito Net 2500 has been installed, the rafter arms can be retensioned.

## 6. Warranty Terms and Conditions

The ARB Awning 2500 comes with a twelve month (12 month) warranty, effective from the date of purchase.

The warranty covers all aspects of workmanship, finish and fabric.

ARB Corporation Ltd will repair at no charge any fault if:

- The fault occurs under normal circumstances, where the awning has been used in accordance with the instructions set out in your owners manual.
- The fault is found to be caused by defective or faulty materials, workmanship or manufacturing process.
- Original proof and date of purchase is provided.

This warranty does not cover transport/postal costs and in-transit insurance costs to/from ARB Corporation Ltd. This warranty applies to the original purchaser and is not transferable.

All faulty goods needing repair must be returned to ARB or your nearest distributor.

ARB Corporation Ltd excepts no responsibility for any damage caused by external factors, i.e. trees, corrugations, shopping centre carparks etc.

**ARB Corporation Limited**  
**Ph: +61 3 9761 6622**  
**[www.arb.com.au](http://www.arb.com.au)**